

# Flour Milling

## VAR Diverter Valves

25



### Description ▼

VAR Diverter Valves consist of a cast aluminium body and cover and a rotary inner drum which closes one of the two outlet pipes as required. The rotation of the inner drum is brought about by means of a pneumatic actuator. The inner sealing is ensured by pneumatically inflatable gaskets.

### Function ▼

VAR Diverter Valves are suitable for conveying any kind of material, both in powdery and granular form. The pneumatic actuator, which activates the inner rotary drum, makes it possible to switch the outlet pipe and thereby divert the flow of material from one duct to another one.



### Application ▼

VAR Diverter Valves are fitted directly to the pneumatic conveying ducts wherever it is necessary to divert the flow of material to different production lines.

### Benefits ▼

- ✓ No contamination due to the 304 SS contact parts inserts;
- ✓ Minimum pressure drop thanks to inflatable seal;
- ✓ Minimum friction during diverting thanks to inflatable seal;
- ✓ ATEX-compliant pneumatic actuator and solenoid valves;
- ✓ Use with different materials in the same configuration;
- ✓ Quick integration into the process thanks to its light weight;
- ✓ Time-saving maintenance thanks to small numbers of components.

# Flour Milling

## VAR Diverter Valves



### Technical Features / Performance ▼

- ▶ Basic structure manufactured from cast aluminium
- ▶ Operating temperature: -20° C to 80° C (-4° F to 180° F)
- ▶ Diverter operating pressure: max. 3.5 bar (36 PSI)
- ▶ Inflatable seal closure pressure: max. 4 bar (58 PSI)
- ▶ Pneumatic actuator activation pressure: max. 8 bar (116 PSI)
- ▶ Diameters from 80mm to 150mm (3 to 6 in)
- ▶ Micro-switch box for signalling actuator position
- ▶ Electro-pneumatic actuator with possibility of different supply voltages 24/48/110/230 V AC

### Overall Dimensions ▼

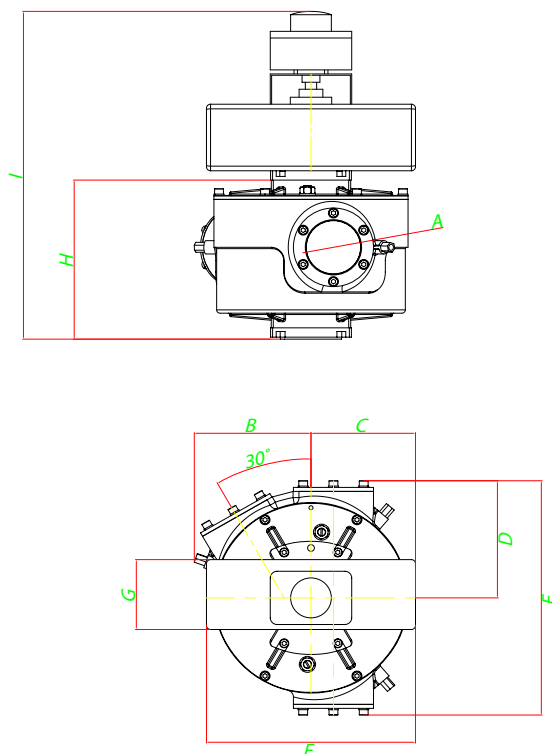

Type	A	B	C	D	E	F	G	H	I	kg
80	80	172	154	176	352	338	106	239	488	30
100	100	198	169	218	436	338	106	265	514	40
125	125	229	192	249	498	384	123	351	613	60
150	150	260	192	278	556	384	123	383	645	78
175	175	310	266	321	642	532	148	421	725	115

*This datasheet might not show the complete range but only the models most suitable for the application.*



TOREX®



[www.wamgroup.com](http://www.wamgroup.com)